

FACTORYLUX®

METAL B22 & B15

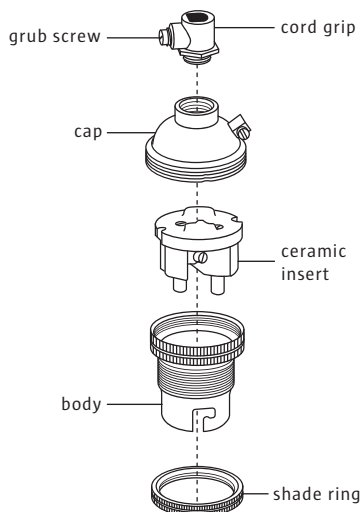

cord grip
 retro silver B22 S251800 | B15 S252600
 vintage brass B22 S251900 | B15 S252700
 antique bronze B22 S252000 | B15 S252800

VARIANTS

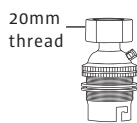

20mm threaded

retro silver B22 S254300 | B15 S256800
 vintage brass B22 S254400 | B15 S256900
 antique bronze B22 S254500 | B15 S257000



hooked

retro silver B22 S253100 | B15 S253900
 vintage brass B22 S253200 | B15 S254000
 antique bronze B22 S253300 | B15 S254100

FACTORYLUX®

USER INSTRUCTIONS

TOOLS REQUIRED

- Cord grip grub screw 4mm flat head screwdriver
- Hooked grub screw 3mm flat head screwdriver
- Terminals 3mm flat head screwdriver

INSTALLATION NOTES

- We recommend using ferrules with crimping pliers to crimp exposed stranded conductors. It's simpler, neater and safer

HANDLING & CLEANING

WARNING: Shut off power and allow to cool

- Wipe gently with a dry, soft, cotton cloth
- Cleaning products, scratching, abrasion, damp, oils, liquids etc may have a detrimental effect on surface patina

YOUR PRODUCT

Thank you for purchasing this Factorylux product. It has been designed and made in the UK to give you many years of reliable service. Please read these user instructions carefully. All user instructions available to download at factorylux.com

WARNING

- Installation in accordance with current wiring and building regs and by a competent person only. Find an NICEIC registered contractor at factorylux.com
- For indoor use only
- Earthed - only compatible with 3 core lighting cable
- Shut off power to the circuit before installation
- Ensure cables are secured in correct terminals (see 'wiring diagram')
- Ensure flexible cables are secure - terminals must be relieved from strain and twisting
- Ensure lugs on cap are aligned with indents on ceramic insert
- Bathroom installation by authorised contractor only
- Do not exceed max operating temperature - 210°C (T2)
- Maintain safe distance between light source and surfaces

TROUBLESHOOTING

No user serviceable parts. In the event of failure, fault or damage shut off power and contact our technical department via factorylux.com

STAY UP TO DATE

We post regular design and product information via social media and our blog. You can also contact us via instant support, twitter or email hello@factorylux.com



WIRING DIAGRAM

- CAUTION:** ⊥ cable must be inserted and secured in the ⊥ terminal inside the cap
1. Strip insulation from end - appropriate to cable type and/or ferrules
 2. Firmly secure stripped cables in terminals **WARNING:** There should be no loose copper strands
 3. Line up lugs in cap with insert indent
 4. Secure grub screw (or suitable alternative cable restraint)

- Cap:

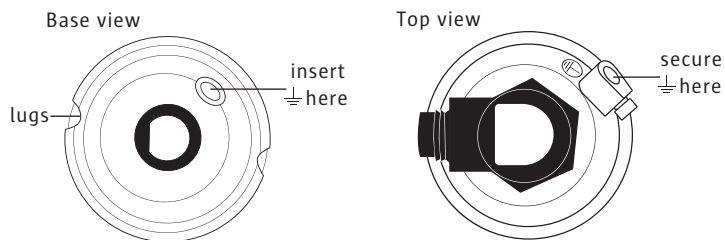

- Insert:

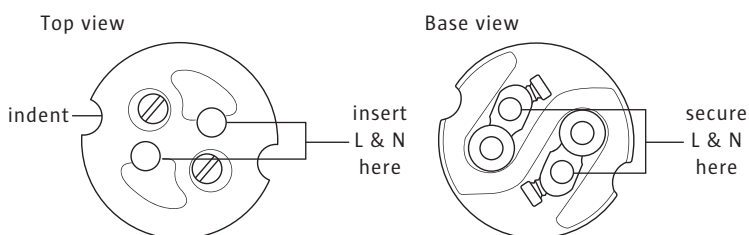

Designed, made & tested in the UK to BS EN 61184
 Revision 1603

